

SEMI-CUSTOM CLAMSHELL USING VISIPAK MOLD BASE PROGRAM

FRONT SIDE OF CLAMSHELL CUSTOMIZED

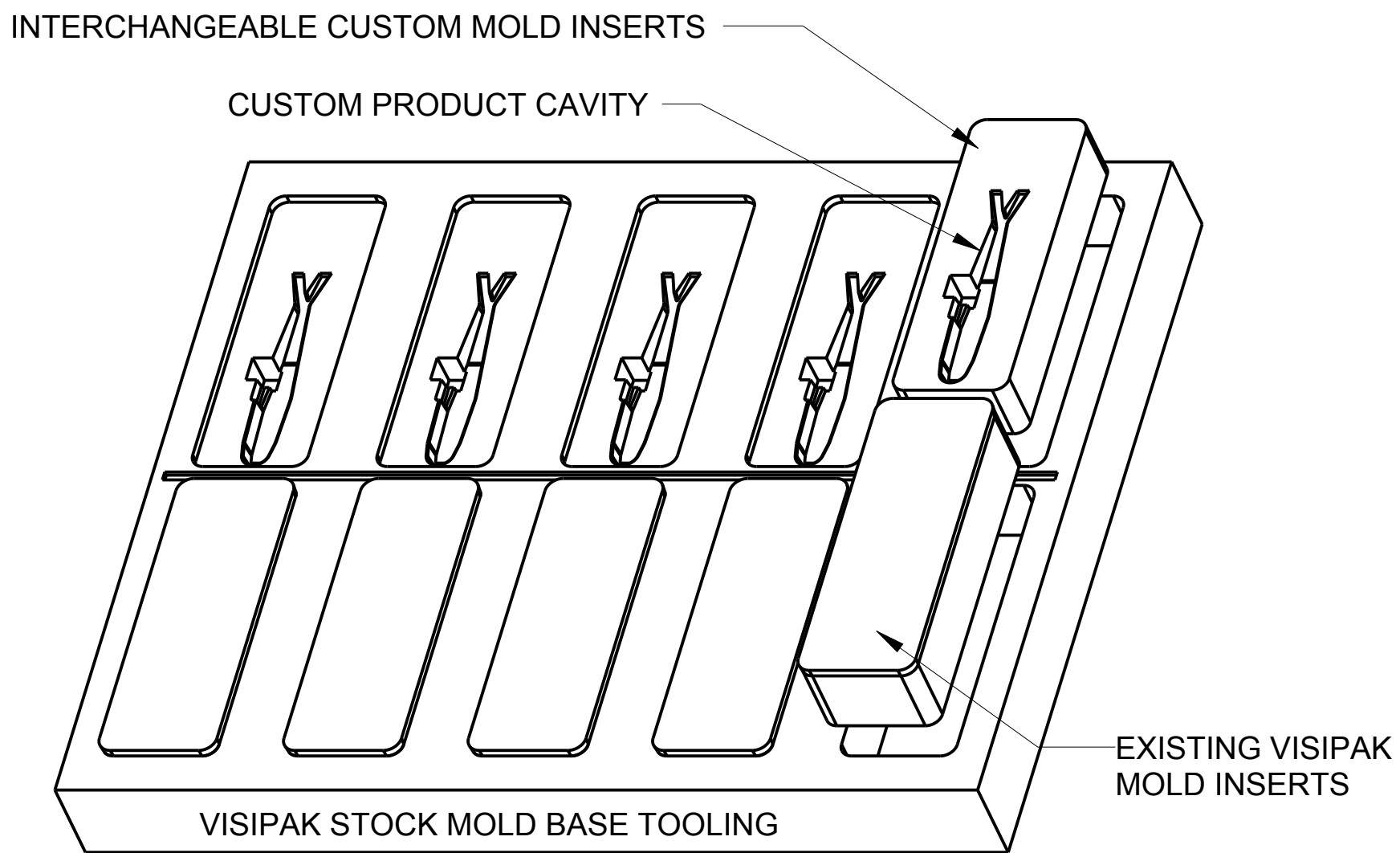

FIGURE 1

FRONT AND REAR SIDES OF CLAMSHELL CUSTOMIZED

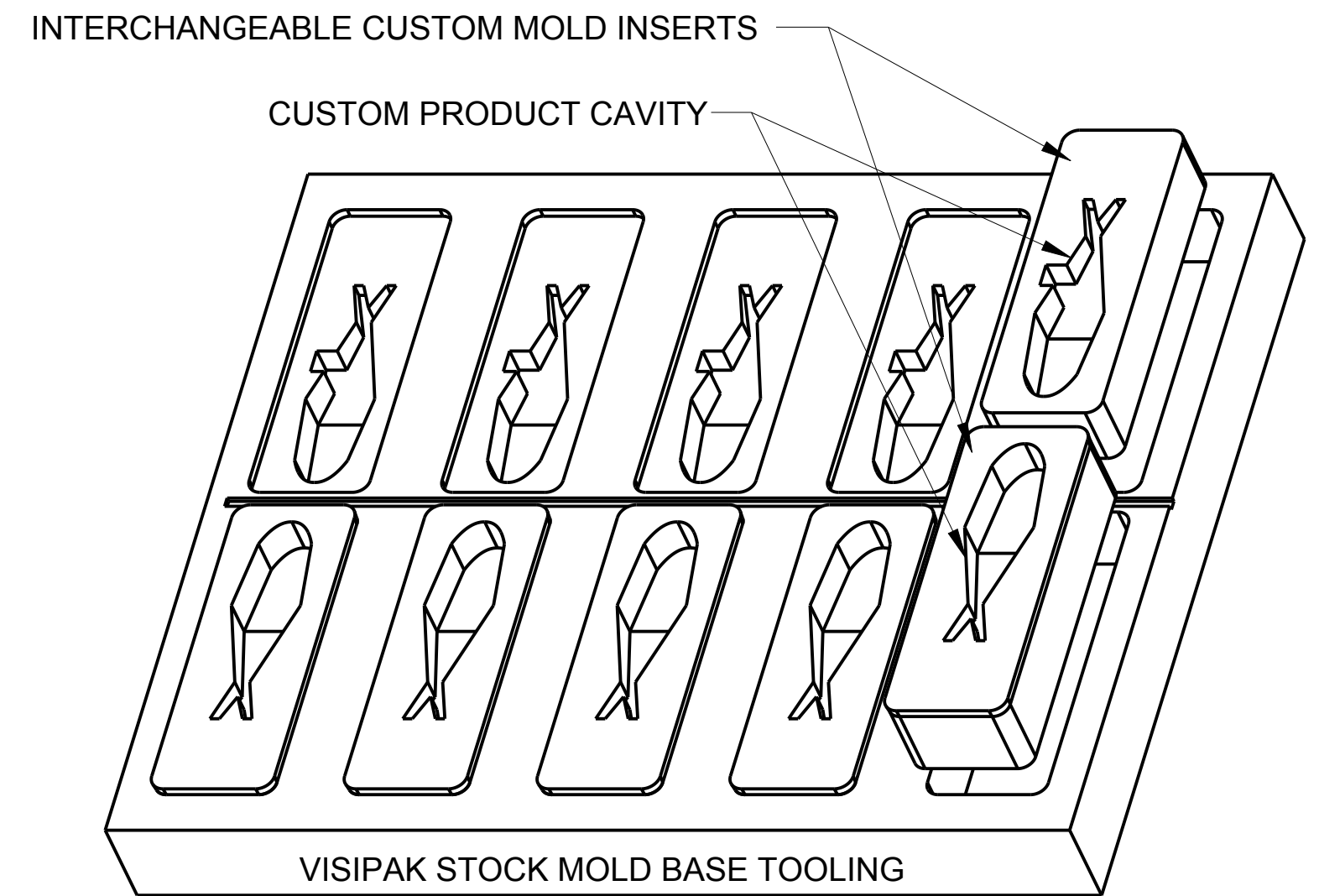
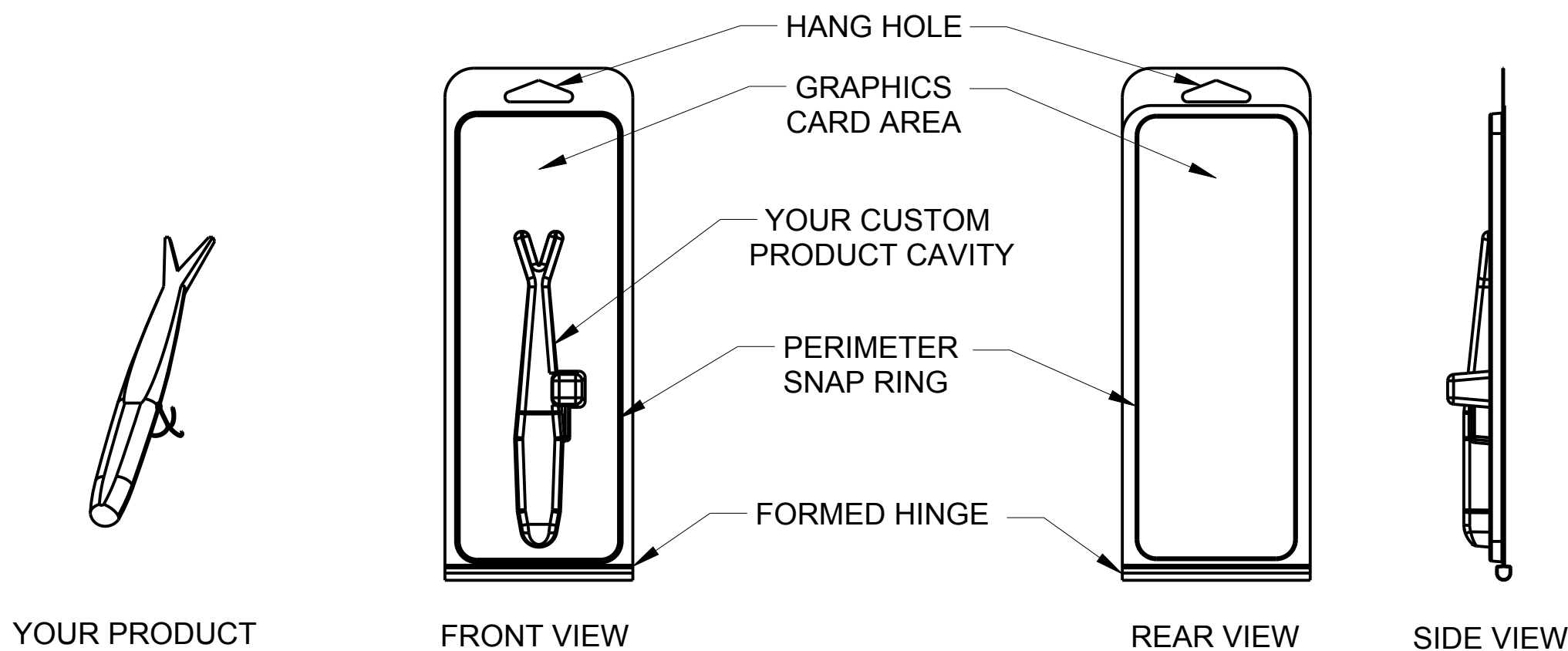
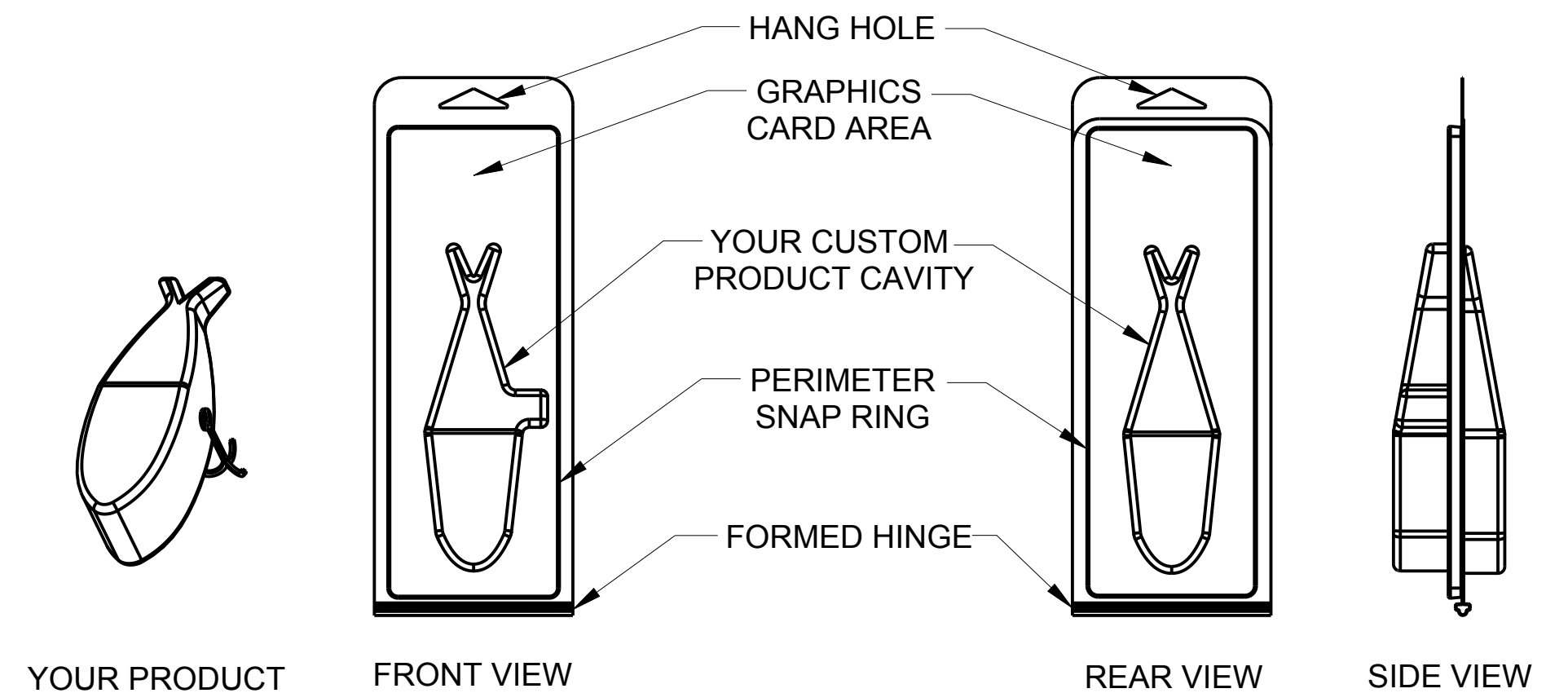

FIGURE 2



SEMI-CUSTOM CLAMSHELL THAT CUSTOM FITS YOUR PRODUCT



SEMI-CUSTOM CLAMSHELL THAT CUSTOM FITS YOUR PRODUCT

A mold is required to produce a clamshell and this consists of two parts: 1) the mold base and, 2) the mold insert. The mold base serves as the tooling or framework in which the insert is placed. Each mold base has a unique footprint within which an infinite number of inserts can be designed to meet your needs. Any Semi-Custom clamshell can be designed with a single customized cavity (and one side flat) or with both sides designed with a customized cavity. Be sure to watch our video for additional review of this concept.