

Stock Clamshells with a Common Mold Base

These images demonstrate clamshells with the same Overall Outside Dimensions, but with variations in the associated cavity and insert card dimensions.

Series 661

Overall Length = 13.000"

Overall Width = 6.188"

The stock clamshells on this page
are made from Mold Base #660

Drawings for concept only. For actual size, see full technical drawings under part details on the VisiPak Ecommerce website.

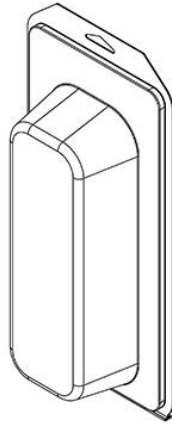

661TF